



CUSTOMEUROPEANPLATES
.COM

Check out all our websites:
www.CustomEuropeanPlates.com
www.CustomEuroPlates.com



CUSTOMEUROPEANPLATES
.COM

Mounting Instructions



1-888-706-2440

support@customeuropeanplates.com

CustomEuropeanPlates.com
1340 Specialty Dr. Suite I
Vista, CA 92081

Clear and easy to understand instructions
for mounting your new European license
plate from CustomEuropeanPlates.com

European Plate Instructions

Mount Plate with Frame

Remove the lower clip from the frame by pulling from the center, out. You will hear the piece snap out of place, and you can continue pulling it out until it is removed from the rest of the frame.



To mount with screws: Remove the plastic washers from the frame indicated by the picture, and use these for the screws if needed. Choose the appropriate holes to screw through into your bumper.

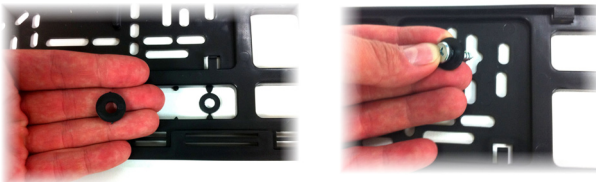

To mount with the 3M Dual Lock kit: Clean your frame and bumper of any dust or dirt and make sure it is dry and free of oil. Apply each piece of velcro at a point of full contact on the back of the frame. After each piece is attached to the frame, peel off the protective liner and adhere to the bumper in the appropriate location. Remove the frame from the bumper so as to prevent unnecessary strain on the adhesive while it sets over the next 24 hours. During this time, the adhesive should be in a dry, moisture-free environment.

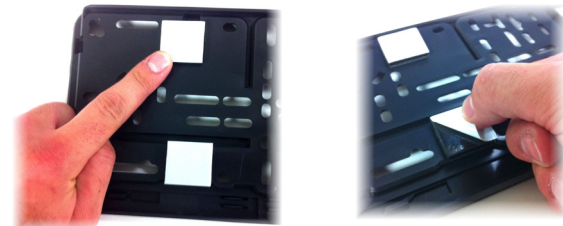

Once the frame is attached to your car, insert the plate from the bottom, up, until it rests beneath the clips on the top and sides. Insert the lower clip back into the frame starting at the ends and working your way towards the middle. You will hear the clip snap back into place on the frame.



Mount Plate without Frame

To mount with screws: Drill the appropriate holes in the plate to match the bumper. If no holes are in the bumper, the corners are typically the best place for screws.



Once the holes are drilled in the plate and bumper, use the screws to install the plate onto the bumper. Using the colored screw caps, attach over top the screws. Eight colored caps are included with the screw kit if ordered from our website; four white, two black, and two blue. If preferred, you can paint the caps to match the color of your plate.



To mount with the 3M Dual Lock kit: Clean your plate and bumper of any dust or dirt and make sure it is dry and free of oil. Apply each piece of velcro at a point where there are no letter indentations which could cause the adhesive or velcro to fail. After each piece is attached to the plate, peel off the protective liner and adhere to the bumper in the appropriate location. Since the plate is maleable, it can stay on the bumper while the glue sets, which takes approximately 24 hours.



Seal Instructions

When customers ask about placement of the seals, we usually recommend to place them between letters on their plate, oriented with the city/region seal on the bottom, and the green expiration seal above. The seals can be applied to the plate in any order and location that you desire, however for simplicity's sake, we will be showing the most authentic placement and location for the seals.

The first step to applying the seals is to make sure the plate is clean and dry so the glue can set properly. Remove the adhesive liner from the back of the city/region seal, and apply the bottom of the sticker to the desired location on the plate. Keeping the top of the sticker away from the plate using your finger, gently slide a credit card up, or something similar, to press the seal firmly to the license plate avoiding air pockets under the seal.



Use the same process for the green expiration seal. Start from the bottom of the sticker. While holding the top, slide a card from the bottom, up to avoid any bubbles.



The finished product should look like the image below.

